

2.5G 850 C EL LD -CA

F

A

Absolute Maximum Ratings:

Parameter	Symbol	Min.	Max.	Unit

Characteristics Ta=25 unless otherwise noted

Parameter	Symbol	Test Conditions	Min.	Typ.	Max.	Unit
	λ					
	$\Delta\lambda$					
	η					

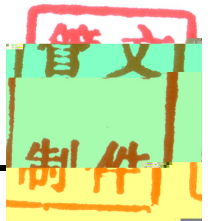

Type F

LD+/PD-/CASE

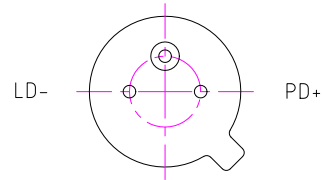

BOTTOM VIEW

I :

LD 850 C EL - - - - -

Statement

